

XAS506 INSTRUCTION MANUAL

If you have any questions along the way, just message to us. We're ready to help!



CAUTION: PLEASE READ ENTIRE MANUAL PRIOR TO USE AND SAVE THESE INSTRUCTIONS.

Before getting started, let's check below lists to make sure it is just right for you!

<p>Does your assembled stand (including accessories) weigh MORE than 11 lbs. (5 kg)?</p>	<p>1</p> <div data-bbox="331 266 518 397"></div> <p>No? Perfect – you may continue. Yes? This mount is NOT compatible.</p> <div data-bbox="954 255 1519 420"><p>CAUTION: DO NOT exceed the maximum weight indicated. This mounting system is intended for use only with the maximum weights indicated. Use with products heavier than the maximum weights indicated may result in collapse of the mount and its accessories, causing possible injury.</p></div>
<p>Do you have all the tools needed? (NOT INCLUDE)</p>	<p>2</p> <div data-bbox="406 453 475 543"></div> <p>Tape Measure</p> <div data-bbox="571 468 737 532"></div> <p>Open-end wrench</p> <div data-bbox="865 468 896 551"></div> <p>1/8"</p> <div data-bbox="989 468 1109 565"></div> <p>Electrodrill</p>
<p>CAUTION</p>	<p>3</p> <p>Never let children climb on product or play with product. Do not sit or stand on product. Do not fasten a speaker that is heavier than the recommended load rating to the mount. Improper installation may cause property damage and/or personal injury, so the installation must be done by two qualified contractors. The manufacture is not liable for damage or injury caused by incorrect mounting, assembly or use. Improper handling can result in cuts and lacerations. Pictures for reference only, subject to our available products. Keep this instruction for future reference.</p>

Dimensions

FRONT VIEW

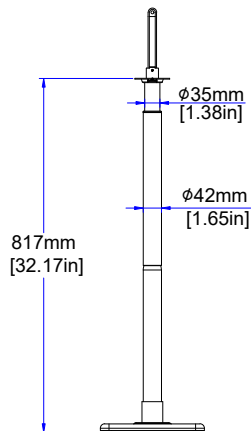

SIDE VIEW

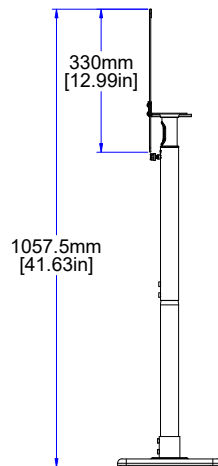

TOP VIEW

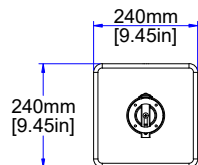

SPEAKER ATTACHMENT UNIT FRONT VIEW

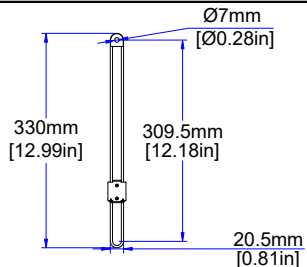

3-D

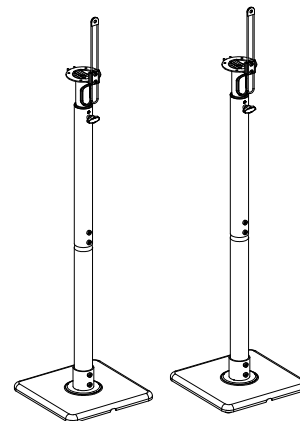

Parts and Hardware

⚠ WARNING: This product contains small items that could be a choking hazard if swallowed. Before starting assembly, verify all parts are included and undamaged. If any parts are missing or damaged, do not return the damaged item to your dealer; contact Customer Service.
Never use damaged parts!

📋 NOTE: Not all hardware included will be used.

Parts and Hardware for STEP 2



L--M4X30 bolt
2pcs



M--M6X30 bolt
2pcs



N--M6X24 key
hole bolt 2pcs



O--M6 Butterfly Nut
2pcs



P--M4 washer
2pcs



Q--M6 spacer
2pcs

Parts and Hardware for STEP 1

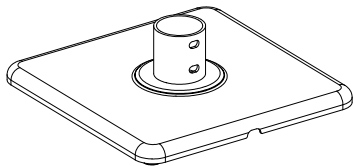

A---Base
2pcs

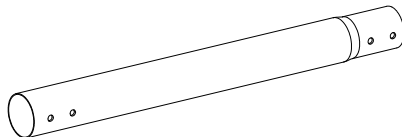

B---Bottom tube
2pcs

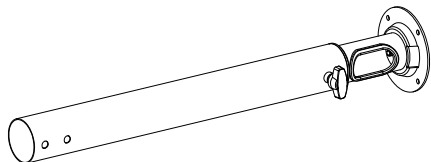

C---Adjusting tube
2pcs

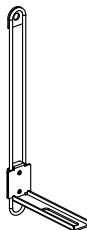

D---Speaker attachment
unit 2pcs



F---M6 Carpet Nail
8 pcs



G---M6 Carpet Nut
8 pcs



H---M6X12 bolt
2pcs



I---M6X8 bolt
8pcs



J---Allen key
1pc

STEP 1 Assemble Product

1-1 Insert bottom tube (B) into base (A), then fasten bolt (I) by using Allen key (J).

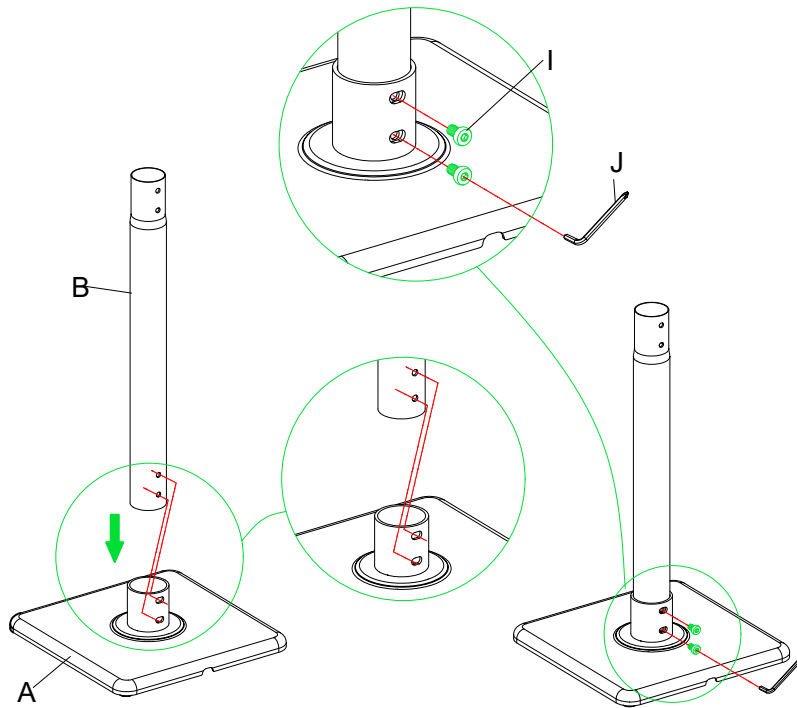

Option: If the stand is placed on carpet, spin to loosen and remove the rubber feet, install the carpet nail (F) and screw to the end, then use the nut (G) to tighten the nail.

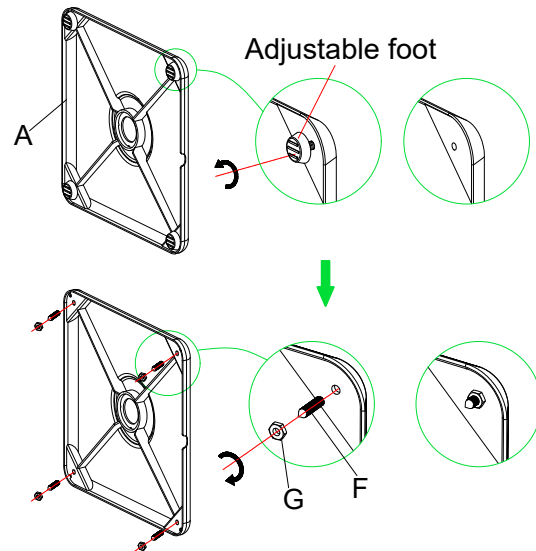

1-2 Insert Adjusting tube (C) into bottom tube (B) and use Allen key (J) to fasten bolt (I).

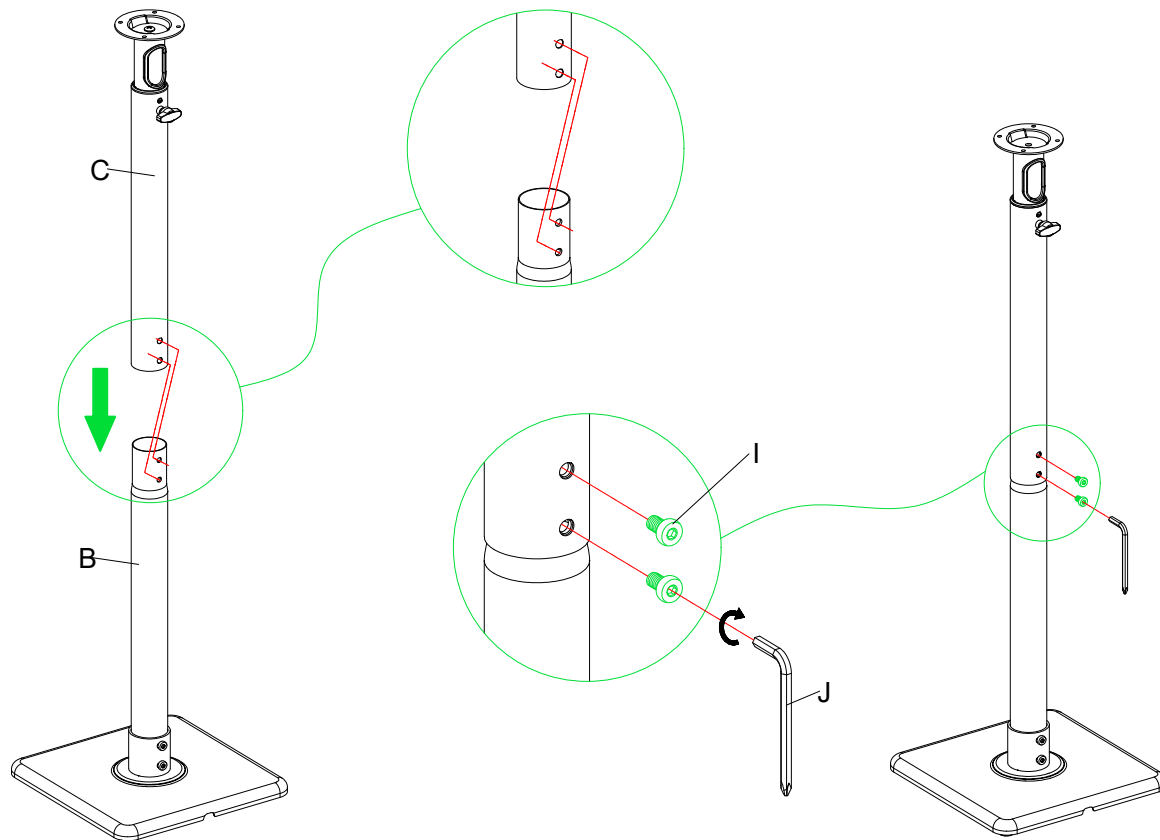

1-3 Attach the Speaker attachment unit (D) to the Adjusting tube (C) and fasten it with bolt (H).

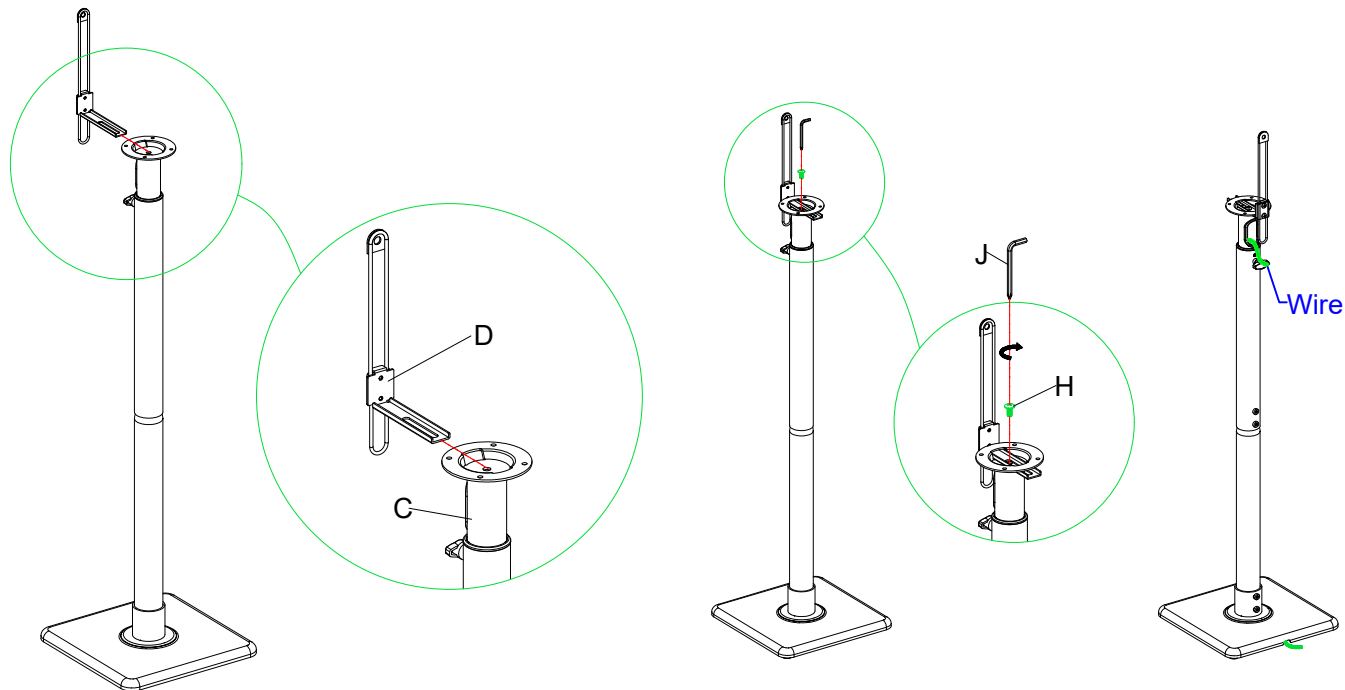

Step 2 Attach speaker to assembled stand

Option 1: According to your speaker's installation hole, choose bolt L/M, washer (P) and spacer (Q) (as shown in Figure 1 and 2) to attach it. Then plug the wires.

For screw hole on flat panel: Use bolt (L/M), washer (P) and spacer (Q) to attach the speaker. M4 washer (P) is only for M4 bolt (L) installation, while no washer is required for M6 bolt (M) installation.

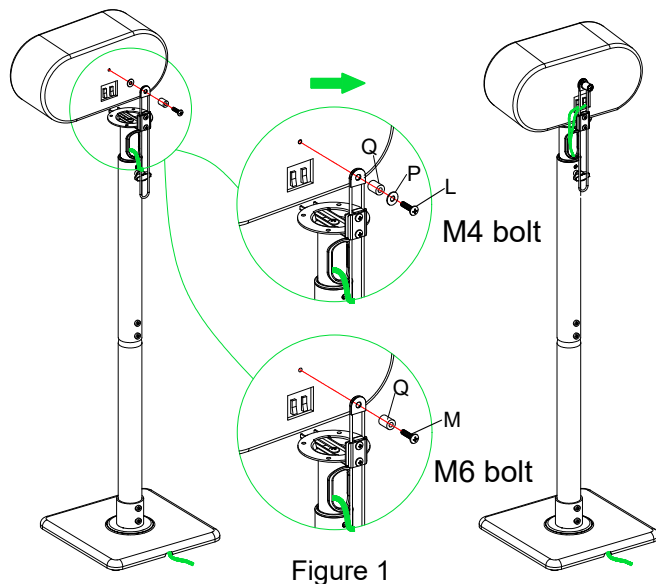

For inset hole: Use bolt (L/M), washer (P) and spacer (Q) to attach the speaker. M4 washer (P) is only for M4 bolt (L) installation, while no washer is required for M6 bolt (M) installation.

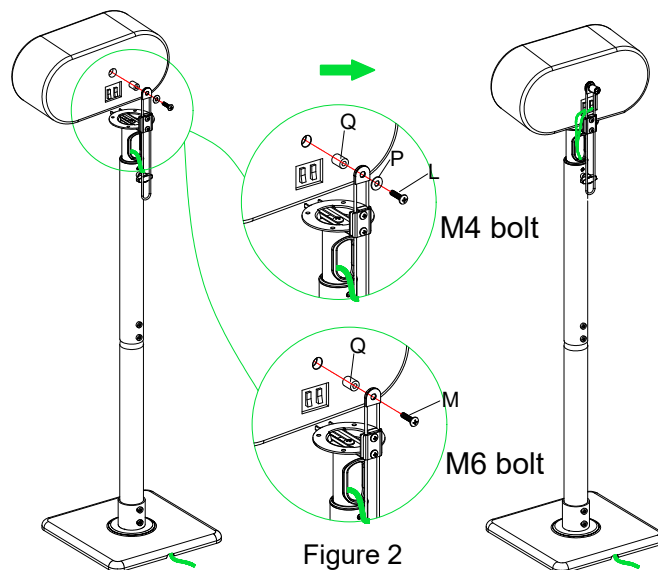

Option 2: For speaker with a key hole, attach key hole bolt (N) to the speaker attachment unit (D) with butterfly nut (O).

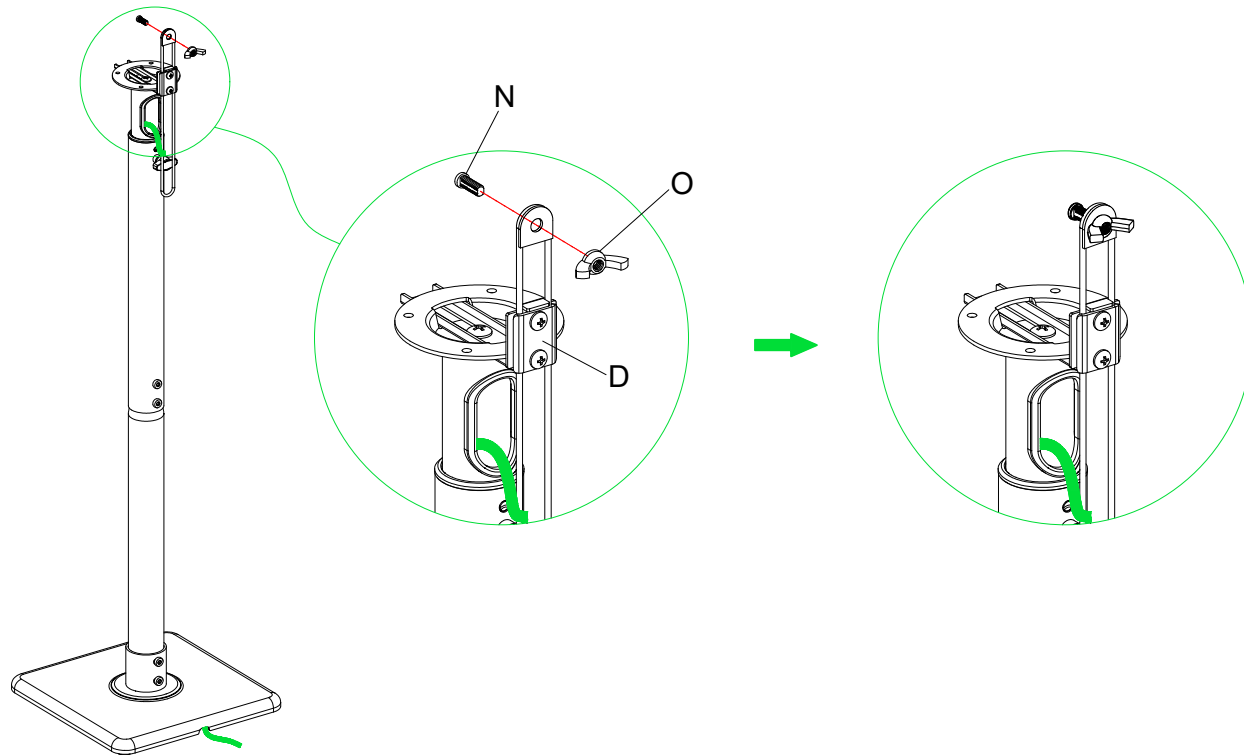

Place speaker on stand with key hole bolt (N) inserted in the key hole, then tighten the butterfly nut (O) and plug the wires.

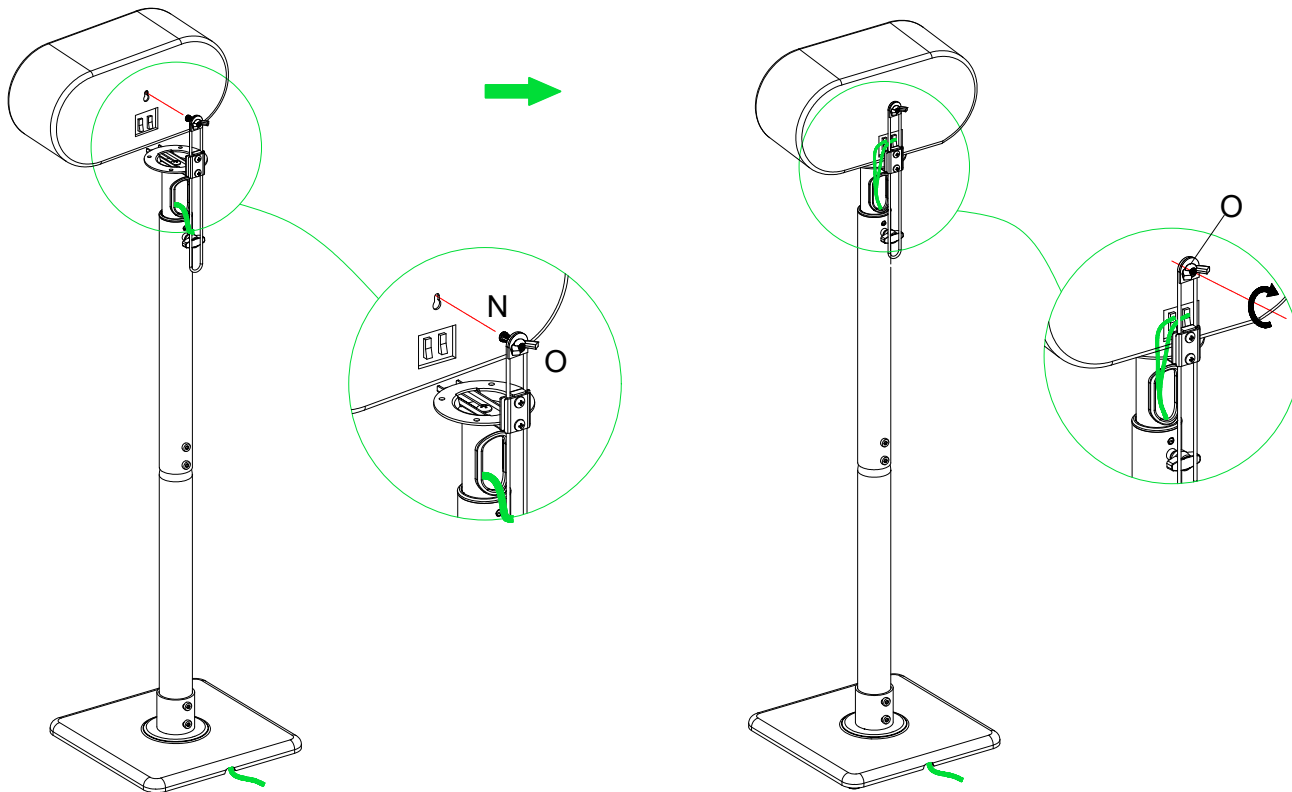

Option 3: Speaker with a wooden base and has no mounting holes at all.

Use wood screws (NOT provided in the package) to mount the speaker. Mark the installation holes' position on the bottom of the speaker and drill holes, then attach the speaker onto speaker stand.

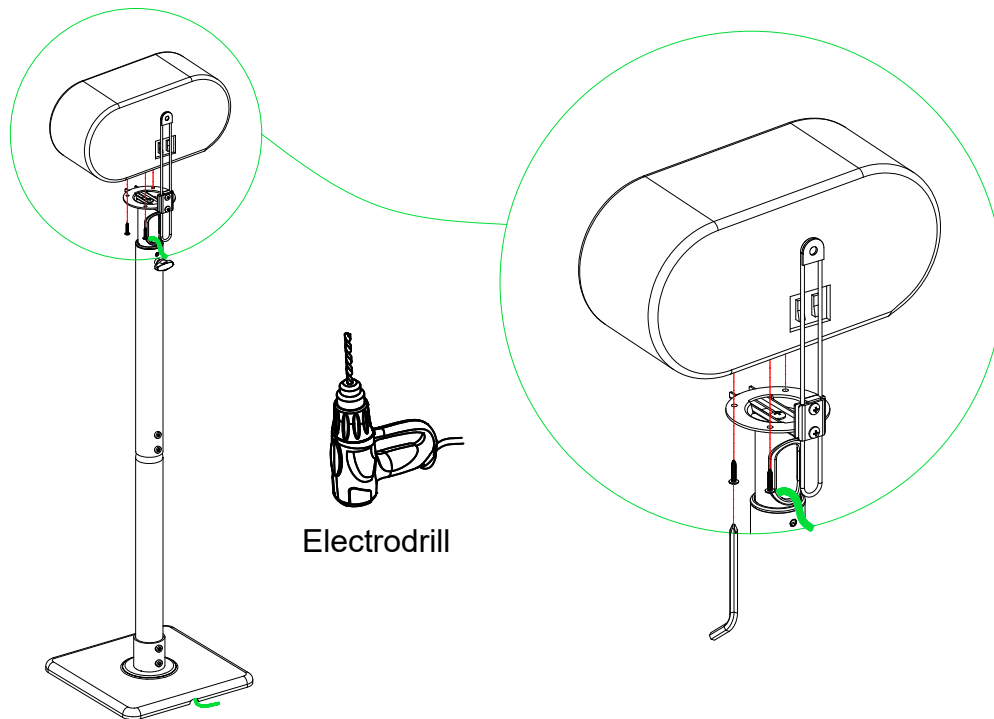

Step 3 Height Adjustment

Loosen the handle, and adjust the tube (C) to desired height, then tighten the handle.

